



Centri Tank Monitor

Solar Powered & Cellular LOGI-4 Series

Owner's Guide

Installation Instructions, Safety, and Warranty Information

Please read this manual carefully before installing and activating.

PATENT NO. 11,859,767



Dear Valued Customer,

Thank you for choosing Centri and the Centri Tank Monitor!

On behalf of the entire team at Centri, I want to express our heartfelt gratitude for selecting our Centri Tank Monitor. We understand that you have a choice when it comes to tank monitoring solutions, and we are honored that you have entrusted us with your purchase.

At Centri, we are committed to delivering high-quality and innovative products that simplify your everyday experiences and bring you peace of mind. Our Michigan-based team has poured their passion and expertise into the design and manufacturing of the Centri Tank Monitor, and we are confident that it will exceed your expectations.

Your satisfaction is our top priority, and we are dedicated to providing you with excellent customer service throughout your journey. Whether you have questions about installation, need assistance with troubleshooting, or simply want to share your feedback, our support team is here for you.

Inside this manual, you will find comprehensive instructions to ensure a smooth and hassle-free installation process. We have designed the Centri Tank Monitor with the utmost user-friendliness in mind, and we believe you will enjoy its solar powered and cellular connectivity capabilities.

Once again, thank you for choosing Centri. We appreciate your trust in Centri, and we are confident that the Centri Tank Monitor will bring you convenience and peace of mind for years to come.

If you have any questions or need assistance, please do not hesitate to contact our customer support team at support@centricconnect.com.

Wishing you an exceptional experience with your new Centri Tank Monitor!

Sincerely,

Nicolas Theoret

CEO

Centri Group Inc.

10381 Citation Dr, Suite 100, Brighton, Michigan 48116

IMPORTANT SAFETY INSTRUCTIONS

The Centri Tank Monitor is designed for the monitoring of commercial tanks ONLY. It should be installed and operated in accordance with the provided instructions and guidelines. Any unauthorized modification or use of the Centri Tank Monitor may void the warranty and could result in damage to the Product or personal injury.

PLEASE READ ALL THE INSTRUCTIONS BEFORE USING THIS DEVICE.

BEFORE INSTALLATION:

Inspect device for any damage. If the device is damaged, discontinue use.

There are no serviceable parts on this device.

Use only as described in this manual. DO NOT use this device for any purpose other than those described in this manual.

DO NOT attempt to modify or repair the device.

For instructions in French or Spanish, contact support@centricconnect.com.

Pour obtenir des instructions en français, contacter support@centricconnect.com.

Para instrucciones en español, contacte a support@centricconnect.com.

SAVE THESE INSTRUCTIONS

CONTENTS

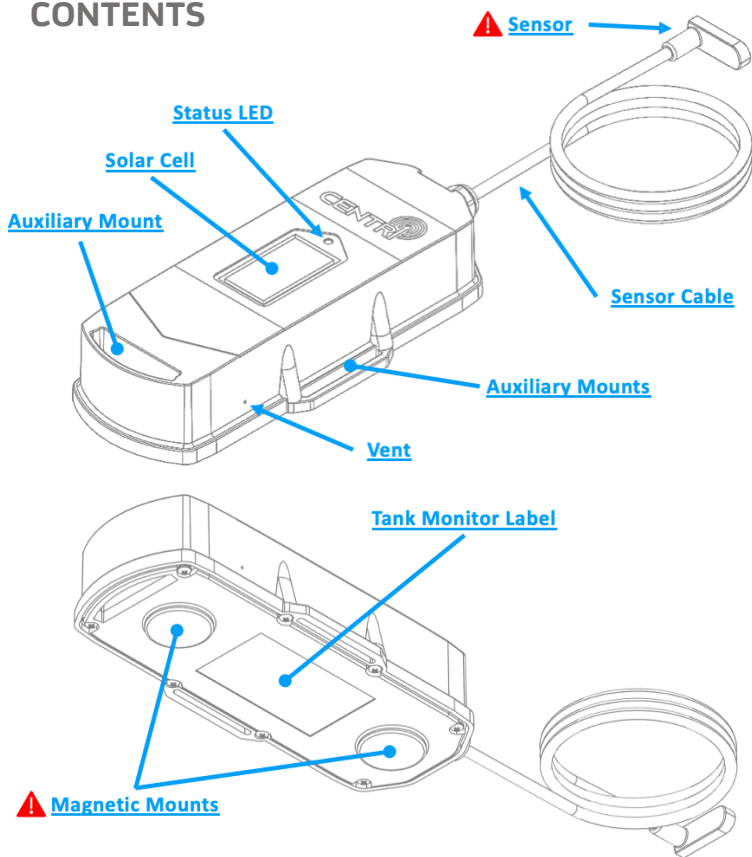

⚠ Warning: Choking Hazard

This product contains small components that pose a choking hazard. Keep away from children under 3 years of age.

⚠ Warning: Strong Magnets

Medical Devices: Keep magnets away from pacemakers, defibrillators, and other medical devices. Magnets can cause interference, potentially leading to malfunction or failure of these devices.

Electronics: Maintain a safe distance between magnets and electronic devices, such as mobile phones, computers, and credit cards. Magnets can cause damage or data loss in these devices.

Injury Risk: Handle magnets with care to avoid pinching fingers or skin. Strong magnetic forces can cause magnets to pinch fingers or skin, which may result in injury.

INSTALLATION INSTRUCTIONS

STEP 1 - Preparation

DO NOT REMOVE THE LIGHT BLOCKER UNTIL STEP 4

Open the top cover of your tank. Inspect the tank dial and confirm that it is a Remote Ready Dial, as shown in *Figure A* below. If you do not have a Remote Ready Dial, please contact us at support@centricconnect.com

The Centri Tank Monitor will not operate correctly without a Remote Ready Dial.

Once the Remote Ready Dial is installed, remove the plastic “Remote Ready” tab as shown in *Figure B* below. Some dials may have the tab already removed.

Continue to Step 2.



Figure A
Remote Ready Dial

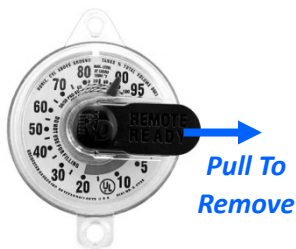

Figure B
*Removing the
“Remote Ready” tab.*

INSTALLATION INSTRUCTIONS

STEP 2 – Sensor Connection

DO NOT REMOVE THE LIGHT BLOCKER UNTIL STEP 4

Next, connect the sensor to the Remote Ready Dial, as shown in *Figure C* below.

Continue to Step 3.

IMPORTANT NOTICE: THE SENSOR MUST BE INSERTED INTO THE REMOTE READY DIAL SLOT IN THE DIRECTION SHOWN IN FIGURE C. FAILURE TO FOLLOW THIS INSTRUCTION PRECISELY MAY RESULT IN DAMAGE TO THE SENSOR AND MAY VOID YOUR WARRANTY.

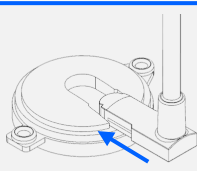
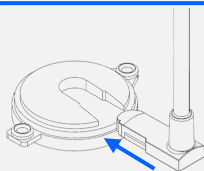
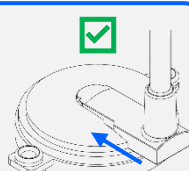

Figure C



Connecting the sensor to the Remote Ready Dial. The sensor must be installed by sliding the sensor into the Remote Ready Dial as shown in the diagram.

Warning

The sensor must be installed correctly, as shown in Figure C. Failure to properly install the sensor into the Remote Ready Dial may result in damage to the sensor which could cause your Centri Tank Monitor to work improperly. Damaging the sensor during installation may void your warranty.

DO NOT INSTALL THE SENSOR AS SHOWN IN FIGURE D & E.



Figure D

DO NOT WEDGE THE SENSOR

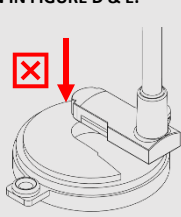
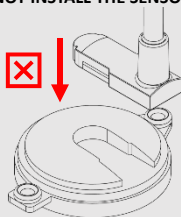
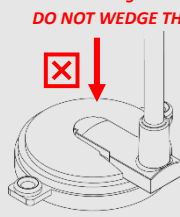

Figure E

**DO NOT INSTALL THE SENSOR VERTICALLY
AS SHOWN**



INSTALLATION INSTRUCTIONS

STEP 3 – Mount Tank Monitor

Option 1: Fuel Tanks

DO NOT REMOVE THE LIGHT BLOCKER UNTIL STEP 4

Next, inspect your fuel tank and identify a location for mounting the Centri Tank Monitor. **To maximize exposure to the sun, the Centri Tank Monitor must be installed on the most sunlit part of the tank with the Solar Cell pointing towards the sun. If you are unsure, place the tank monitor on the south facing part of the tank.** Ensure that the installation surface is clear and free from debris, such as snow, dirt, dust, sand, etc. Use the magnetic mounts on the bottom of the tank monitor to mount. Additionally, ensure that the sensor cable is not pinched, squeezed, or compressed by the tank cover.

IMPORTANT NOTICE: DAMAGING THE CABLE MAY RESULT IN IMPROPER FUNCTIONALITY AND MAY VOID YOUR WARRANTY.

Continue to Step 4.

Sensor cable free from obstructions, pinching, squeezing, or compression.

Tank monitor installed on the most sunlit or south facing portion of the tank.

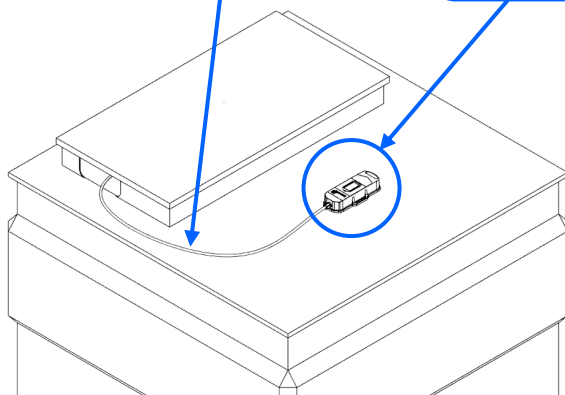

Figure F

Centri Tank Monitor installed on a Portable Fuel Tank.

INSTALLATION INSTRUCTIONS

STEP 3 – Mount Tank Monitor

Option 2: Above Ground Propane Tanks

DO NOT REMOVE THE LIGHT BLOCKER UNTIL STEP 4

Next, inspect your propane tank and identify a location for mounting the Centri Tank Monitor. **To maximize exposure to the sun, the Centri Tank Monitor must be installed on the most sunlit part of the propane tank with the Solar Cell pointing towards the sun. If you are unsure, place the tank monitor on the south facing part of the tank.** Ensure that the installation surface is clear and free from debris, such as snow, dirt, dust, sand, etc. Use the magnetic mounts on the bottom of the tank monitor to mount. Additionally, ensure that the sensor cable is not pinched, squeezed, or compressed by the tank cover.

IMPORTANT NOTICE: DAMAGING THE CABLE MAY RESULT IN IMPROPER FUNCTIONALITY AND MAY VOID YOUR WARRANTY.

Continue to Step 4.

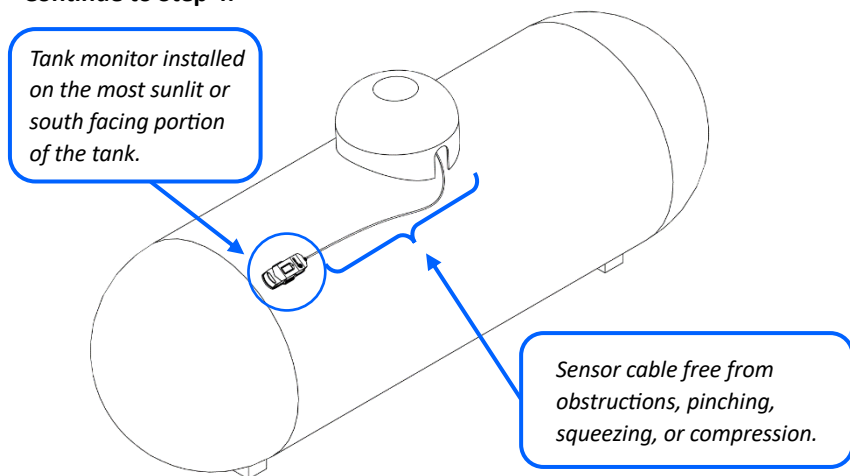

Figure F

Centri Tank Monitor installed on an Above Ground Propane Tank.

INSTALLATION INSTRUCTIONS

STEP 3 – Mount Tank Monitor

Option 3: Under Ground Propane Tanks

DO NOT REMOVE THE LIGHT BLOCKER UNTIL STEP 4

Next, inspect your underground tank hatch cover and identify a location for mounting the Centri Tank Monitor. **To maximize exposure to the sun, the Centri Tank Monitor must be installed on the top hatch cover with the Solar Cell facing upwards.** Ensure that the installation surface is clear and free from debris, such as snow, dirt, dust, sand, etc. When using the recommended secure mounting methods listed below, only the auxiliary mounting holes on the enclosure must be used. Do not modify, puncture, cut, or drill into the Centri Tank Monitor's enclosure. Additionally, ensure that the sensor cable is not pinched, squeezed, or compressed by the tank cover.

IMPORTANT NOTICE: MODIFYING THE CENTRI TANK MONITOR'S ENCLOSURE WILL VOID THE WARRANTY. ADDITIONALLY, DAMAGING THE CABLE MAY RESULT IN IMPROPER FUNCTIONALITY AND MAY VOID YOUR WARRANTY.

Continue to Step 4.

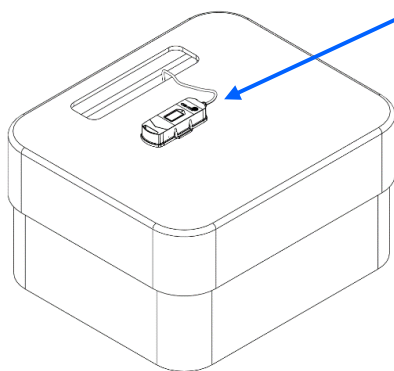

Tank monitor installed to the top of an underground tank hatch cover.

Recommended secure mounting method to the hatch cover:

- Magnetic Mounts
- Zip Ties
- Weatherproof Double-Sided Tape
- Weatherproof Velcro

Figure G

Centri Tank Monitor installed on an underground tank hatch cover.

INSTALLATION INSTRUCTIONS

STEP 4 – Activation

Remove the light blocker and direct sunlight to the Solar Cell to activate the Centri Tank Monitor, per *Figure H* below.

If you are installing the Centri Tank Monitor in the dark, you may need to use a light source, such as a flashlight, to activate the device.

Once activated, the Status LED will start blinking yellow. This means that the device is activating and connecting to the cellular network. This may take up to 10 minutes to complete. You can connect to your device on the CentriConnect app during the cellular connectivity process (Step 5).

Once connected to the cellular network, the Status LED will start blinking green. This means that the device has successfully connected to the cellular network and has completed its activation cycle. After 30 minutes, the Status LED will cease to blink green. If the Status LED starts blinking red, please contact us at support@centriconnect.com.

Continue to Step 5.

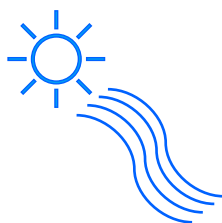

- *Device is activating and connecting to network.*
- *Device is activated and connected.*
- *Device failed activation.
Contact support@centriconnect.com*

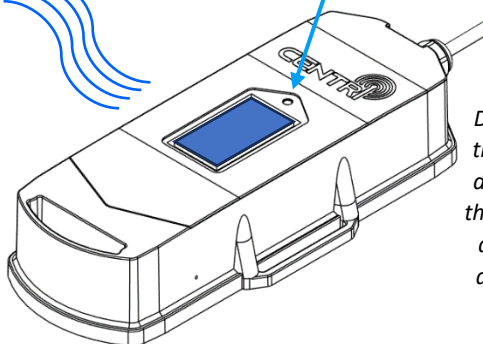

Figure H

Direct light towards the Solar Cell on the device. You may use the sun or a flashlight as a light source to activate the device.

INSTALLATION INSTRUCTIONS

STEP 5 – Connecting Your Device

Download the **CentriConnect App** on the Google Play Store or the Apple App Store.



Create an account.

Once logged in, select “Add Monitor”, and follow the steps on the **CentriConnect App** to connect to your Centri Tank Monitor.

The QR Code of the **Device ID** can be found on the bottom of the device, as shown in *Figure 1 below*, or on the device activation card which was delivered with the product.

The device authentication code can be found on the device activation card delivered with the product. If you lose your device activation card or your device authentication code, please contact support@centriconnect.com and send your **Device ID** along with a picture of your device’s QR code label.

Continue to Step 6.

Figure 1
*Location of the Device ID
and QR Code.*

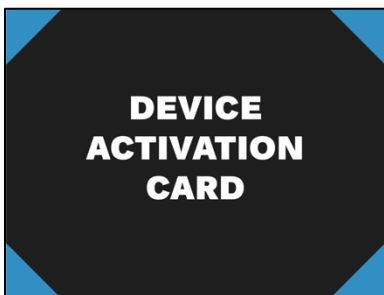
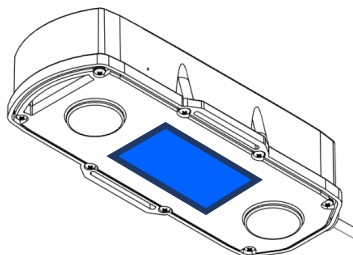

SAVE THIS CARD	
Follow along on the app and read the instructions carefully to properly install, activate, and connect to your tank monitor.	
When asked on the app to scan your Device ID , you may scan this QR Code to enter your Device ID . You may also scan the QR Code on the bottom of your tank monitor.	<div>Device ID</div> <div>QR Code</div>
When prompted on the app, enter the Device Authentication Code below to authenticate ownership and complete the connection process.	
Device Authentication Code: XXXXXX	
Device ID: Serial Number:	

INSTALLATION INSTRUCTIONS

STEP 6 – Monitor Your Tank!

Congratulations! You're ready to start monitoring your tank with the freedom of solar charging and cellular connectivity! Follow along on the app to edit and modify your tank monitor settings.

If you see this after following the prompts to add a device, your device has been successfully connected!

The latest tank level reading.

Press the tile to see your tank monitor information, as shown in Figure K.

Edit your device settings here.

Your tank monitor's latest post timestamp.

Your latest tank level reading.

Your notification settings. Emails and push notifications are sent when your tank level breaches these thresholds.



Figure J

Home Screen on the CentriConnect App.

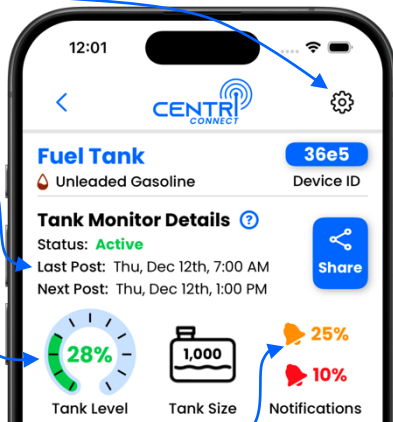

Figure K

Tank Monitor Detail screen on the CentriConnect App.

TERMS & CONDITIONS

Disclaimer of Liability

Please read this disclaimer carefully before installing or using the Centri Tank Monitor (the "Product"). By installing or using the Product, you agree to be bound by the terms and conditions set forth in this disclaimer.

Installation and Use

The Product is designed for commercial fuel & propane tanks only. It should be installed and operated in accordance with the provided instructions and guidelines. Any unauthorized modification or use of the Product may void the warranty and could result in damage to the Product or personal injury.

Safety Precautions

Users are advised to follow all safety precautions and warnings provided in the product documentation. Failure to do so may result in electric shock, fire, or other hazards. The manufacturer is not liable for any injury, damage, or loss arising from the failure to adhere to safety guidelines.

Limited Warranty

The Product is covered by a limited warranty as outlined in the accompanying warranty documentation. The warranty covers defects in materials and workmanship under normal use and conditions. It does not cover damage resulting from misuse, accidents, unauthorized repairs, or alterations.

Limitation of Liability

Centri's software, which includes mobile and desktop applications ("Services"), provides information ("Product Information") about your Centri products, and connected peripherals ("Product Peripherals"). The types of Product Peripherals may change over time. Without limiting the scope of the above disclaimers, all Product Information is provided "as is" and "as available" for your convenience. Centri does not make any representations, warranties, or guarantees regarding the availability, accuracy, or reliability of Product Information, or that using Product Information, Services, or Products will ensure safety in your home or business.

You use all Product Information, Services, and Products at your own discretion and risk. Centri disclaims any liability for any loss, damage, or injury, including but not limited to damage to your wiring, fixtures, electrical system, home, business, Product, Product Peripherals, computer, mobile device, and all other items and pets in your home or business, arising from your use of Product Information, Services, or Products.

Product Information provided by the Services is not intended to replace direct methods of obtaining information. For example, notifications provided through the Services are not substitutes for audible and visible alerts in the home or business and on the Product, nor for third-party monitoring services that monitor alarm states.

Limitation of Damages

In addition to the above disclaimers, Centri will not be responsible for any consequential, incidental, exemplary, or special damages, including but not limited to loss of data or loss of profits, resulting from, or related to this Limited Warranty or the Product. Centri's total cumulative liability arising from or related to this Limited Warranty, or the Product, shall not exceed the original purchase price paid by the buyer for the Product.

Indemnification

You agree to indemnify and hold the manufacturer, its affiliates, officers, directors, agents, and employees harmless from any claim or demand, including reasonable attorneys' fees, made by any third party due to or arising out of your use of the Product, your violation of these terms, or your violation of any rights of another.

LIMITED WARRANTY INFORMATION

This Limited Warranty contains important information about your rights and obligations, as well as limitations and exclusions that may apply to you.

Warranty Coverage

Centri Group Inc. ("Centri") warrants the owner that the enclosed product ("Product") will be free from defects in materials and workmanship for a period of two (2) years from the date of delivery following the original retail purchase ("Warranty Period").

Remedies

If the Product fails to conform to this Limited Warranty during the Warranty Period, Centri will, at its sole discretion:

- Repair or replace the defective Product or component with a new or refurbished product or component, or
- Accept the return of the Product and refund the original purchase price.

If the Product or any component is no longer available, Centri may replace it with a similar product of similar function. This Limited Warranty provides your sole and exclusive remedy for any breach of warranty.

Warranty Period for Repairs and Replacements

Any repaired or replaced Product will be covered under this Limited Warranty for the longer of:

- Ninety (90) days from the date of delivery of the repaired or replaced Product, or
- The remaining Warranty Period.

Transferability

This Limited Warranty is transferable from the original purchaser to subsequent owners, but the Warranty Period will not be extended or expanded for any transfer.

Total Satisfaction Return Policy

If you are the original purchaser of the Product and are not satisfied for any reason, you may return the Product in its original condition within thirty (30) days of the original purchase for a full refund.

Warranty Conditions, How to Get Service Under This Limited Warranty

To make a claim under this Limited Warranty, the Product owner must:

- Notify Centri of the intention to claim by emailing support@centriconnect.com during the Warranty Period and providing a description of the alleged failure.
- Comply with Centri's return shipping instructions.

Centri will have no warranty obligations for a returned Product if it determines, in its reasonable discretion, that the Product is an Ineligible Product (defined below).

What This Limited Warranty Does Not Cover

This Limited Warranty does not cover the following ("Ineligible Products"):

- Products marked as "sample" or "Not for Sale," or sold "AS IS."
- Products subjected to:
 - Modifications, alterations, tampering, or improper maintenance or repairs.
 - Handling, storage, installation, testing, or use not in accordance with Centri's instructions.
 - Abuse or misuse of the Product.
 - Breakdowns, fluctuations, or interruptions in electric power or telecommunications networks.
 - Acts of God, including but not limited to lightning, floods, tornadoes, earthquakes, or hurricanes.

This Limited Warranty does not cover software (even if packaged or sold with the product). Centri recommends using authorized service providers for maintenance or repair. Unauthorized use of the Product or software can impair performance and may invalidate this Limited Warranty.

Disclaimer of Warranties

Unless explicitly stated in this Limited Warranty, and to the fullest extent permitted by applicable law, Centri disclaims all express, implied, and statutory warranties and conditions related to the Product, including implied warranties of merchantability and fitness for a particular purpose. Additionally, Centri restricts the duration of any implied warranties or conditions to the term of this Limited Warranty.

Your Rights and This Limited Warranty

This Limited Warranty grants you specific legal rights. You may also have other rights that vary by state, province, or jurisdiction. Some limitations in this Limited Warranty may not apply in certain areas. The terms of this Limited Warranty will apply to the extent allowed by applicable law. For a full description of your legal rights, refer to the laws applicable in your jurisdiction and consider contacting a relevant consumer advisory service.

Updates to Terms & Warranty

The manufacturer reserves the right to update or modify these terms and conditions at any time without prior notice. Users are encouraged to review this legal section periodically for changes. By proceeding with the installation and use of the Product, you acknowledge that you have read, understood, and agreed to the terms and conditions outlined in this legal section.

Making a Warranty Claim

To make a warranty claim, the Customer must:

1. Contact the Company's customer service department at support@centricconnect.com to obtain a Return Merchandise Authorization (RMA) number.
2. Ship the defective Product, along with a copy of the original purchase receipt and the RMA number, to the address provided by Centri.

Governing Law

This warranty is governed by the laws of Michigan, United States, without regard to its conflicts of law principles.

Effective Date

This warranty is effective as of January 1st, 2024.

Copyright © 2024 Centri Group Inc., All Rights Reserved

support@centricconnect.com

Centri Group Inc.,

10381 Citation Dr, Suite 100

Brighton, Michigan 48116

